



TOYOTA

ALWAYS A
BETTER WAY

How to tether Bluetooth



Connected
Services

Pair your phone via Bluetooth: Overview

Step 1 – Click on “Setup”.

Step 2 – Click on “Bluetooth”.

Step 3 – If no device is registered a message will be displayed.

Step 4 – Ensure Bluetooth on your smartphone is switched on.

Step 5 – Click on “Add new device”.

Step 6 – Click on your device.

Step 7 – Select “pair”.

Step 8 – Your device is connected to the multimedia system.

Step 9 – Multiple devices can be connected to the multimedia system.

Step 10 – Bluetooth tethering : APPLE users turn on “personal Hotspot”. ANDROID users select "Tethering & portable hotspot" and "Bluetooth tethering”.

Pair your phone via Bluetooth: Step 1

Click on “Setup”.

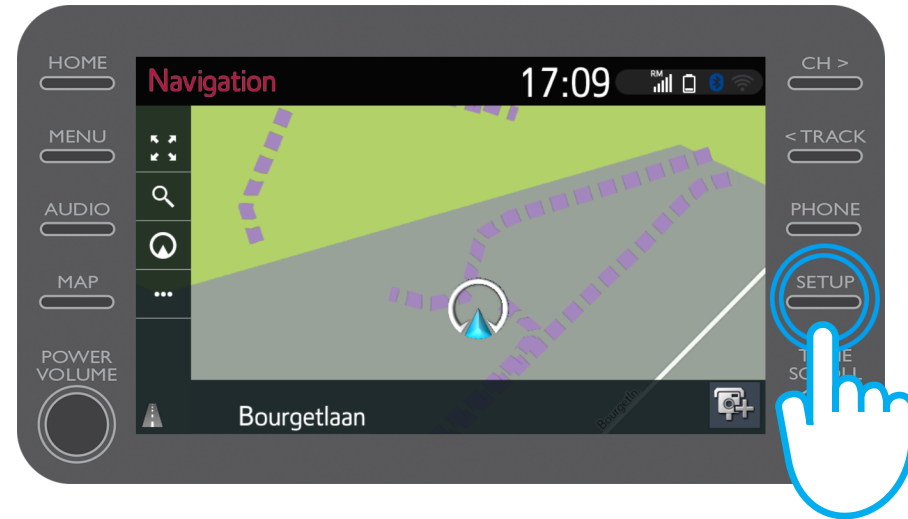

Pair your phone via Bluetooth: Step 2

Click on “Bluetooth”.

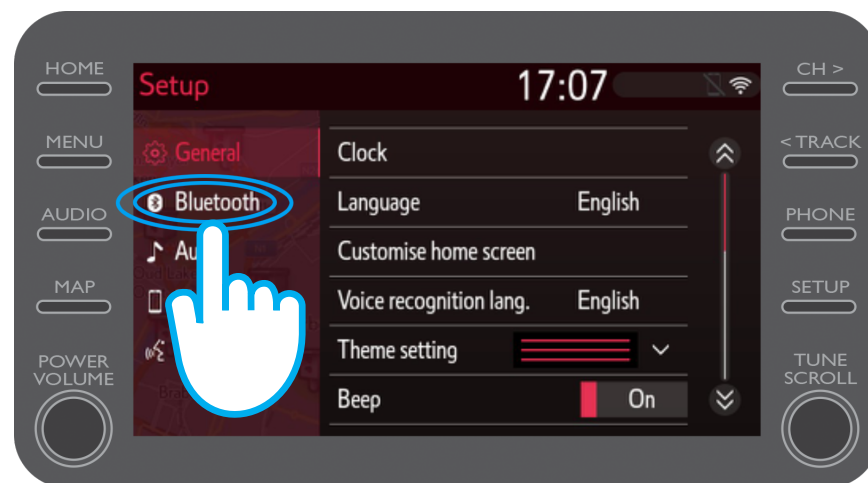

Pair your phone via Bluetooth: Step 3

If no Bluetooth device is registered, this screen will be displayed.

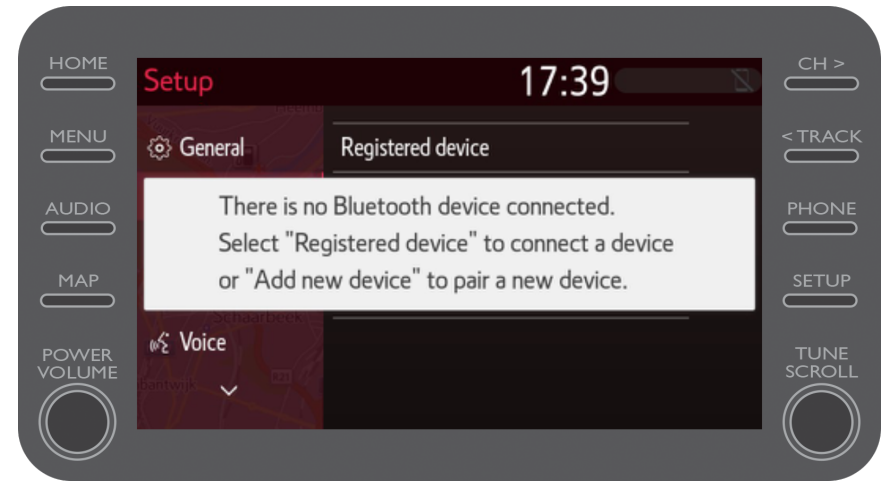

Pair your phone via Bluetooth: Step 4

Ensure Bluetooth on your smartphone is switched on.

The Bluetooth symbol should be displayed.

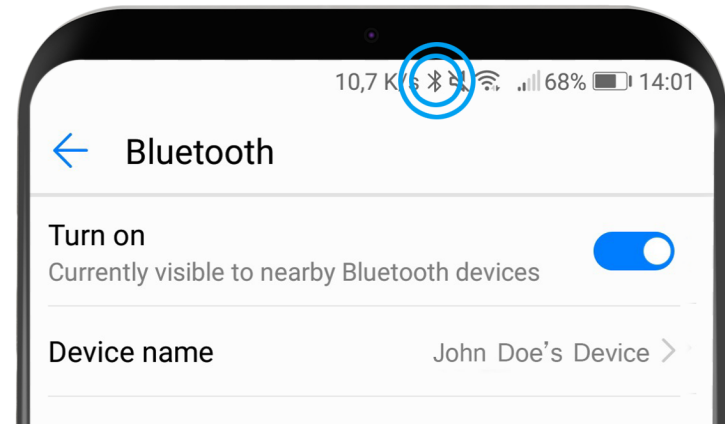

Pair your phone via Bluetooth: Step 5

Click on “Add new device”

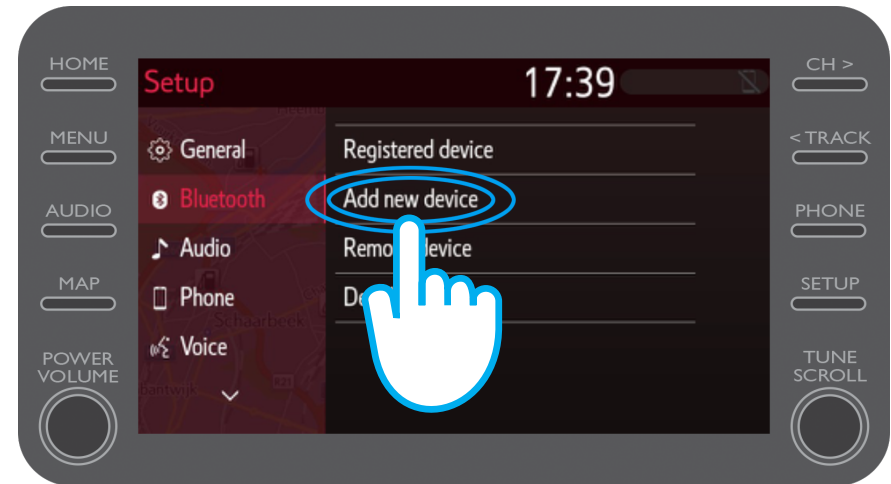

Pair your phone via Bluetooth: Step 6

Click on your device.

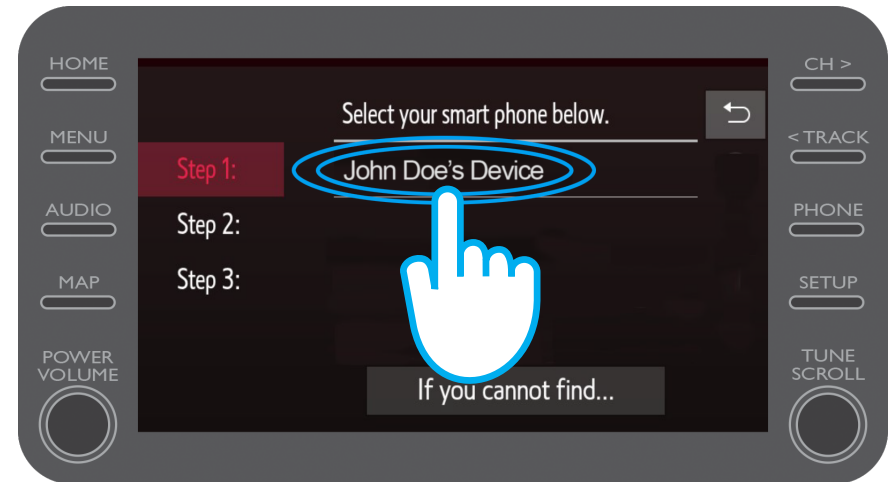

Pair your phone via Bluetooth: Step 7

A request is sent to your device.
Select “Pair” on your device.

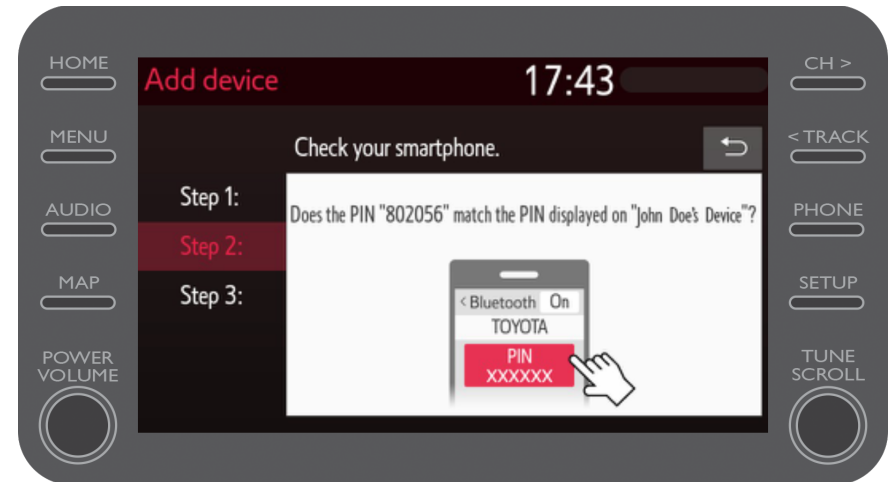

Pair your phone via Bluetooth: Step 8

Your device has been connected to the multimedia system.

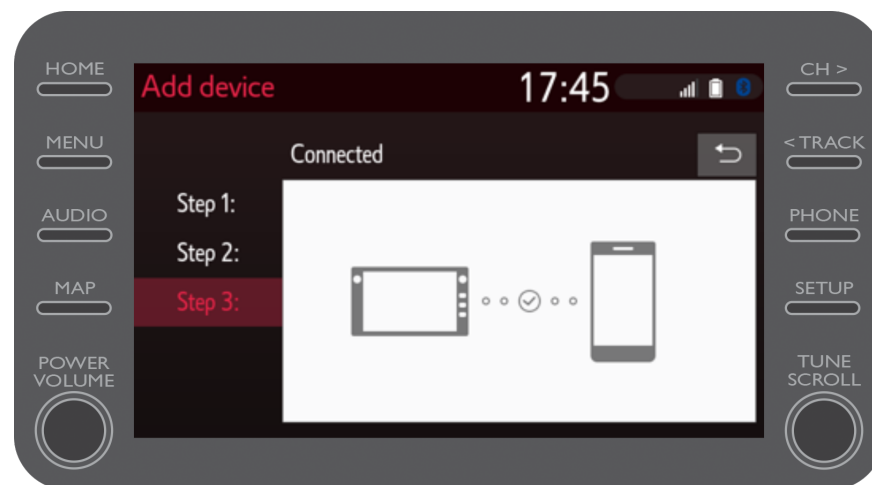

Pair your phone via Bluetooth: Step 9

Multiple devices can be connected to the multimedia system.

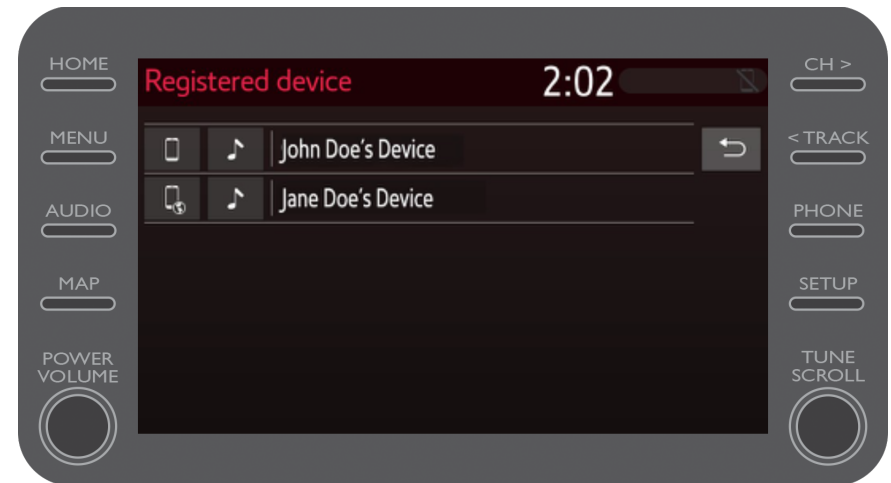

Pair your phone via Bluetooth: Step 10

Now that your smartphone is connected to the car by Bluetooth, enable Bluetooth tethering on your smartphone.

Depending on your phone type:

For **APPLE** users: Tether Bluetooth

1. Please connect your phone and your multimedia system to Bluetooth
2. Go to phone settings>Bluetooth>ON.
3. Go back to settings>Personal Hotspot>ON.

For **ANDROID** users: (Example only, older devices may require a different process)

1. Please connect your phone and your multimedia system to Bluetooth.
2. Go to phone settings>wireless & networks>tethering & portable hotspot>Bluetooth tethering.

MyT | Multimedia

Life happens when you connect

MyT | Connected
Services